

Spring-Die Mould Part Industry Company Limited

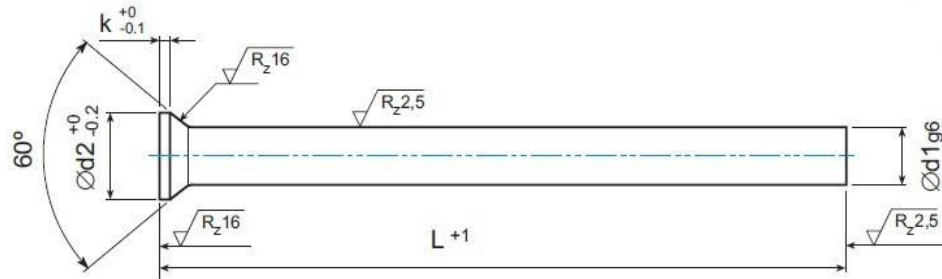

DIN9861-D PUNCH

Material: 1.3343, 1.2516, 1.2080 Hardness: body HRC62~66, head HRC45~50

d1(h6)	L (+ 0.5 / 0)											
	71	HWS	WS	80	HWS	WS	100	HWS	WS	130	HWS	WS
0.50-0.95												
1.00-1.70												
1.75-2.50												
2.55-2.95												
3.00-3.40												
3.50~3.90												
4.00-4.40												
4.50~4.90												
5.00-5.40												
5.50~5.90												
6.00-6.40												
6.50-7.40												
7.50-8.0												
8.50-9.0												
9.50-10.0												
10.5-11.0												
11.5-12.0												
12.5~13.0												
13.5~14.0												
14.5~15.0												
15.5~16.0												
16.5~17.0												
17.5~18.0												