

Spring-Die Mould Part Industry Company Limited

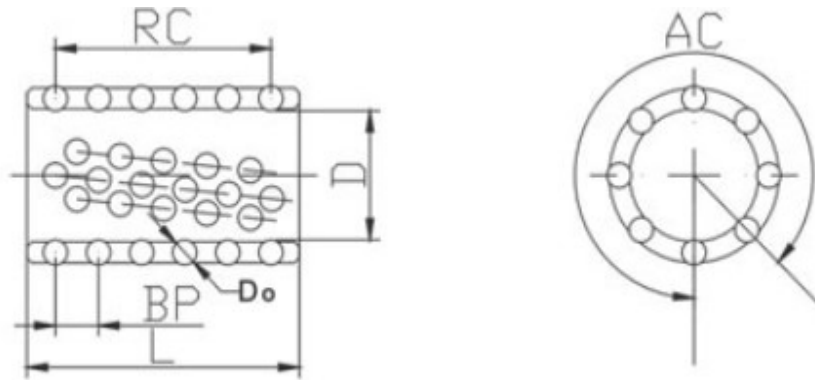

Compact Ball Cage 密珠型钢珠套

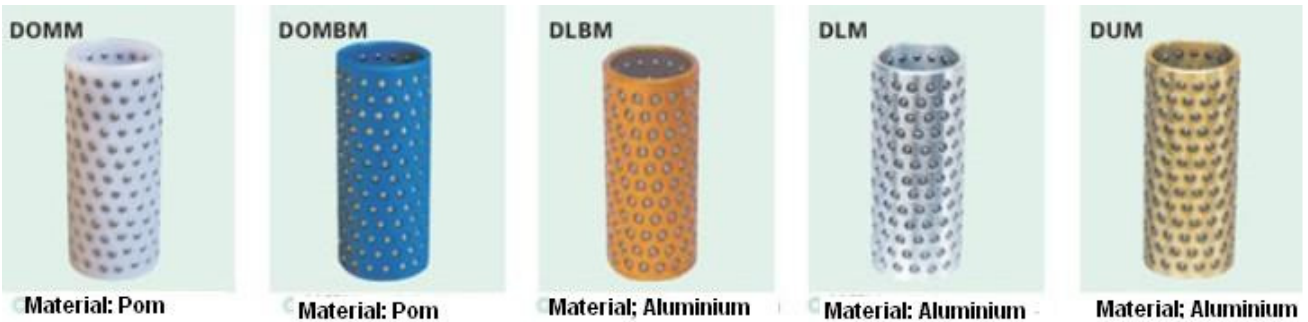

Common steel ball specification									
Φ 1.0	Φ 1.5	Φ 2 (2.5)	Φ 3	Φ 3.176	Φ 4	Φ 4.76	Φ 5	Φ 6	Φ 6.35

Specification D*L	Guide post diameter	Length	Hole number (AC)	Row Number (RC)	Steel Ball Diameter (Do)	Steel Ball Number (Balls)	Stell Ball Distance (BP)
5*10	5	10	8	4	1	32	1.8
5*20		20	8	10	1	80	
6*20	6	20	8	10	1	80	1.8
6*30		30	8	14	1	112	
10*35	10	35	10	8	2	80	3.5
10*40		40	10	10	2	100	
12*30	12	30	10	7	2	70	3.5
12*40		40	10	10	2	100	
16*30	16	30	10	10	2	100	2.3
16*35		35	10	13	2	130	
16*30		30	12	6	3	72	4
16*35		35	12	7	3	84	
18*40	18	40	12	8	3	96	4
18*50		50	12	10	3	120	
19*50	19	50	12	11	3	132	4
19*60		60	12	13	3	156	
20*50	20	50	12	11	3	132	4
20*60		60	12	13	3	156	
22*50	22	50	16	9	3	144	5
22*60		60	16	11	3	176	
25*50	25	50	18	9	3	162	5
25*60		60	18	11	3	198	
25*70		70	18	13	3	234	

Specificati on D*L	Guide post diamater	Length	Hole number (AC)	Row Number (RC)	Steel Ball Diameter(Do)	Steel Ball Number (Balls)	Stell Ball Distance(BP)
28*50	28	50	18	9	3	162	4.5
28*60		60	18	12	3	216	
28*70		70	18	14	3	252	
28*80		80	18	16	3	288	
28*60	28	60	16	10	4	160	5
28*70		70	16	12	4	192	
28*80		80	16	14	4	224	
31*50	31	50	18	7	4	126	5.5
31*60		60	18	9	4	162	
31*70		70	18	11	4	198	
31*80		80	18	13	4	234	
32*50	32	50	18	8	4	144	5.5
32*60		60	18	9	4	162	
32*70		70	18	11	4	198	
32*80		80	18	13	4	234	
36*50	36	50	20	8	4	160	5.5
36*60		60	20	9	4	180	
36*70		70	20	11	4	220	
36*80		80	20	13	4	260	
38*50	38	50	20	5	5	100	6.5
38*60		60	20	8	5	160	
38*70		70	20	9	5	180	
38*80		80	20	11	5	220	
38*90		90	20	12	5	240	
40*80	40	80	20	11	5	220	6.5
40*90		90	20	12	5	240	
42*70	42	70	20	9	5	180	6.5
42*80		80	20	11	5	220	
42*90		90	20	12	5	240	
45*70	45	70	20	9	5	180	6.5
45*80		80	20	10	5	200	
45*90		90	20	12	5	240	
45*100		100	20	13	5	260	
45*110		110	20	15	5	300	
50*70	50	70	22	9	5	198	6.5
50*80		80	22	10	5	220	
50*90		90	22	12	5	264	
50*100		100	22	13	5	286	
50*110		110	22	15	5	330	
60*80	60	80	26	10	5	260	6.5
60*90		90	26	12	5	312	
60*100		100	26	13	5	338	
60*110		110	26	15	5	390	
60*120		120	26	16	5	416	